



Above: 74 year old John Sambrook makes light work of pitch covering at Leighton Buzzard Cricket Club.
An 80' by 40' Climate Cover weighs only 45kg and is so easy to use that one person can cover 3 or 4 pitches by themselves.

Climate Cover is a revolutionary advancement in sports turf covering.

Climate Cover is the only 100% waterproof sports turf flat sheet covering system designed to promote the health of the grass plant and is, "Simply the strongest, lightest and only breathable ground cover".

The Climate Cover system has evolved through the experience and expertise of groundsmen, agronomists and material specialists and is now used at test match grounds, county grounds, schools and local league clubs.

Made from a unique material, the Climate Cover system provides an extremely lightweight and practical waterproof cover, enabling large areas to be covered easily and safely with minimum labour.



Climate Cover serves as a more practical and inexpensive solution to raised mobile pitch covers

Website: www.climatecover.co.uk

Telephone: 01604 750 555

email: info@climatecover.co.uk

The health of the plant is essential for it to perform and with-stand the stresses it endures from surface preparation and play. Climate Cover is made from an extremely strong translucent and breathable material, which allows light to pass through, ensuring the grass plant continues to grow underneath.

The grass plant is not harmed through the covering process. Therefore the system can remain on a natural turf surface for an indefinite length of time without harming the grass plant and damaging the surface.

Independent tests showed that when used as a propagation cover, seed germination is dramatically enhanced.

Climate Cover also prolongs the growing season, as the ability to cover the surfaces for long periods of time maintains ground temperature and therefore promotes growth. Acting as an insulation layer, Climate Cover allows the light and air to diffuse through while increasing ground temperature.

Handling equipment has been developed to provide practical and labour-saving methods for covering all types of sports surface.

Manufactured to highest possible standards, Climate Cover Systems can be tailored to suit each customer's individual requirements. Bespoke systems can be designed to suit any site and therefore benefit all natural sports surfaces.



Total Turf Solutions

One trusted resource for your sports surfaces

Climate Cover is a subsidiary company of Total Turf Solutions Ltd

Climate Cover System™ The latest in pitch covering technology

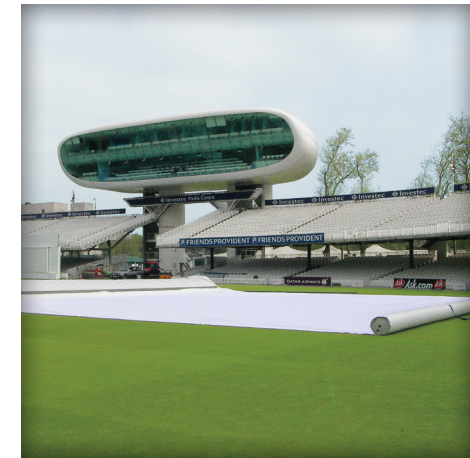

Simply the strongest, lightest and only breathable sports cover

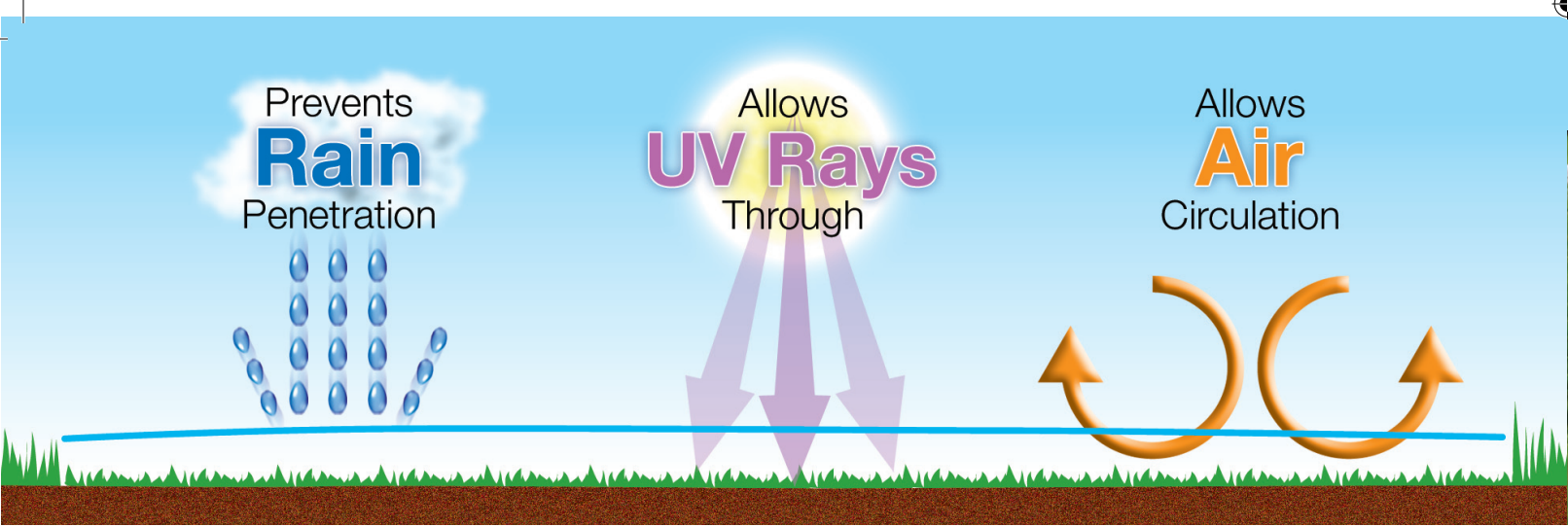

Test conducted covering one section of grass with ClimateCover and not covering the other section. Image shows results after 7 days.



“Now we have used the cover first hand, and tested in a real-life situation, I cannot praise the system enough. Normally when using covers for long periods of time we would have big problems with disease, but with Climate Cover it is minimal. To our amazement the covers actually make the grass grow.”

Michael Hunt, Head Groundsman, Lord's Cricket Ground



“Light and easy to use plus they are the best germination covers I have ever had. If I had these covers fifteen years ago I wouldn't have problems with my elbows now. They are wonderful!”

Steve Rouse, Head Groundsman, Warwickshire County Cricket Club, Edgbaston, Birmingham, UK

“The covers are great, just what we needed. We use Climate Covers instead of wheeled mobile covers. One man even in strong winds can cover our pitches. It is a lot easier and we can also cover a larger area than normal raised covers. Perfect for squares on a slope.”

Roger Brown, Ryelands & St Crispins Cricket Club, Northampton UK

“The best covers we have ever had. Leaving the covers on now is not a problem and because one man can put the cover on by himself, it has also freed up staff.”

Andrew Matthews, Grounds Manager, Harrow School, London UK



Feature	Benefit
Lightweight	Lower operational costs Less labour needed for handling and use Increased practicality, easier to use Safer to use and handle
Translucent	Healthier plant when covered Cover can stay on for long periods
Breathable	Good air circulation, reduces 'sweating' Less susceptible to disease
Strength	Guarantees on handles, eyelets & seams No tearing/ripping No inconvenience of repairs and costs